

# HF3508A (JA3508A)

# FLASHER



### Typical Applications

Turning lamp & Flashing lamp control

### Features

- Special integrate circuit, good performance
- Special high-powered contacts, ultra-long life
- Surface mounting technology, advanced craftwork
- Solid base design, stable structure
- Good capability of EMC

## CHARACTERISTICS

Norminal voltage	12VDC
Operating voltage range	9VDC to 16VDC
Contact rating	Lamp: 2×21W+5W 13.5VDC
	Lamp: 4×21W+2×5W 13.5VDC
Flashing frequency	(80±15)OPS/min
Lamp failure flashing frequency	(170±20)OPS/min
Energizing ratio	40% to 60%

Electrical endurance (continuous)	1000h (2×21W + 5W)
	360h (4×21W + 2×5W)
Ambient temperature	-40°C to 85°C
Vibration resistance	10Hz to 200Hz 49m/s <sup>2</sup>
Shock resistance	196m/s <sup>2</sup>
Weight	Approx. 36g
Mechanical data	Cover retention: 250N min.
	Terminal retention: 100N min.

## OUTLINE DIMENSIONS AND WIRING DIAGRAM

Unit: mm

Wiring Diagram

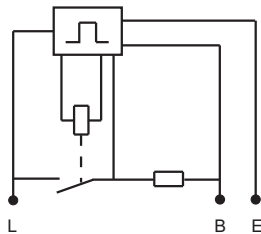

1. As shown in left wiring diagram, for HF3508A, terminal B is connected with anode of 12VDC, terminal E with cathode, and terminal L with lamp load.
2. When the lamp load is 2×21W + 5W or 4×21W + 2×5W, the relay will control lamp flashing with the frequency (65 to 95) times / minute.
3. When the lamp load is 1×21W + 5W (one 21W lamp fails), the relay will control lamp flashing with the frequency (150 to 190) times / minute.

Terminal Layout

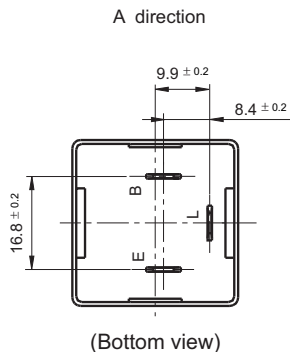

Outline Dimensions

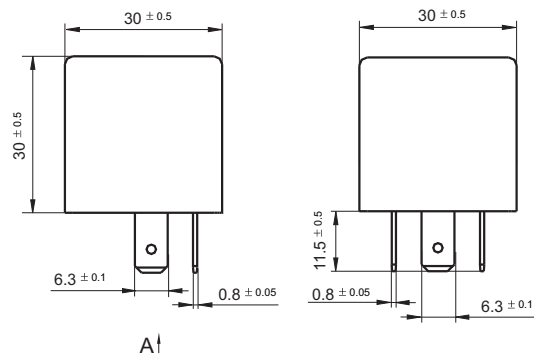

HONGFA RELAY

ISO9001, ISO/TS16949, ISO14001, OHSAS18001, IECQ QC 080000 CERTIFIED

2008 Rev. 1.00